

Advanced Modeling using Creo Parametric

Overview

Course Code	WBT-3403
Course Length	24 Hours

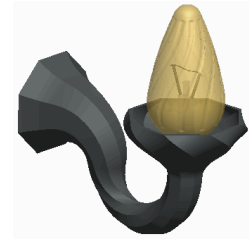

The Advanced Part Modeling using Creo Parametric training course teaches you how to use advanced part modeling techniques in Creo Parametric to improve your product designs. In this course, you will learn how to create and modify design models using advanced sketching techniques and feature creation tools. You will also learn how to reuse existing design geometry when creating new design models. After completing this course, you will be well prepared to work efficiently with complex product designs using Creo Parametric.

At the end of each module, you will complete a skills assessment. The questions are used to help reinforce your understanding of the module topics and form the basis for review of any topics, if necessary.

Course Objectives

- Learn advanced selection techniques
- Create advanced datum features
- Use advanced sketching techniques
- Create advanced holes
- Create advanced drafts and ribs
- Create advanced shells
- Create advanced rounds and chamfers
- Use relations and parameters
- Create advanced blends
- Create sweeps with variable sections
- Create helical sweeps
- Create swept blends
- Learn advanced layer techniques
- Learn how to use different advanced reference management techniques
- Create family tables
- Reuse features
- Learn advanced copy techniques
- Create advanced patterns

Prerequisites

- Introduction to Creo Parametric
 - Update to Creo Parametric from Creo Elements/Pro 5.0
-

Audience

- This course is intended for mechanical designers, design engineers and related roles. The topics in this course are also available as Web-based training courses.

Table of Contents

Module	1	Advanced Selection
Module	2	Advanced Datum Features
Module	3	Advanced Sketching
Module	4	Advanced Hole Creation
Module	5	Advanced Drafts and Ribs
Module	6	Advanced Shells
Module	7	Advanced Rounds and Chamfers
Module	8	Relations and Parameters
Module	9	Advanced Blends
Module	10	Sweeps with Variable Sections
Module	11	Helical Sweeps
Module	12	Swept Blends
Module	13	Advanced Layers
Module	14	Advanced Reference Management
Module	15	Family Tables
Module	16	Reusing Features
Module	17	Advanced Copy
Module	18	Advanced Patterns
